

5/01/2003 Assembly Notes:

Item 21,22 permanent press fit in Basetube Brackets

Item 23 removeable fit in bottom leg plug (one side is flared for tight fit). Retains sidewire, VG bearing, washers and spacers

Item 24 removeable fit, assembly aid for FR-RR wires in bottom leg plug

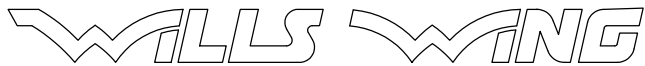
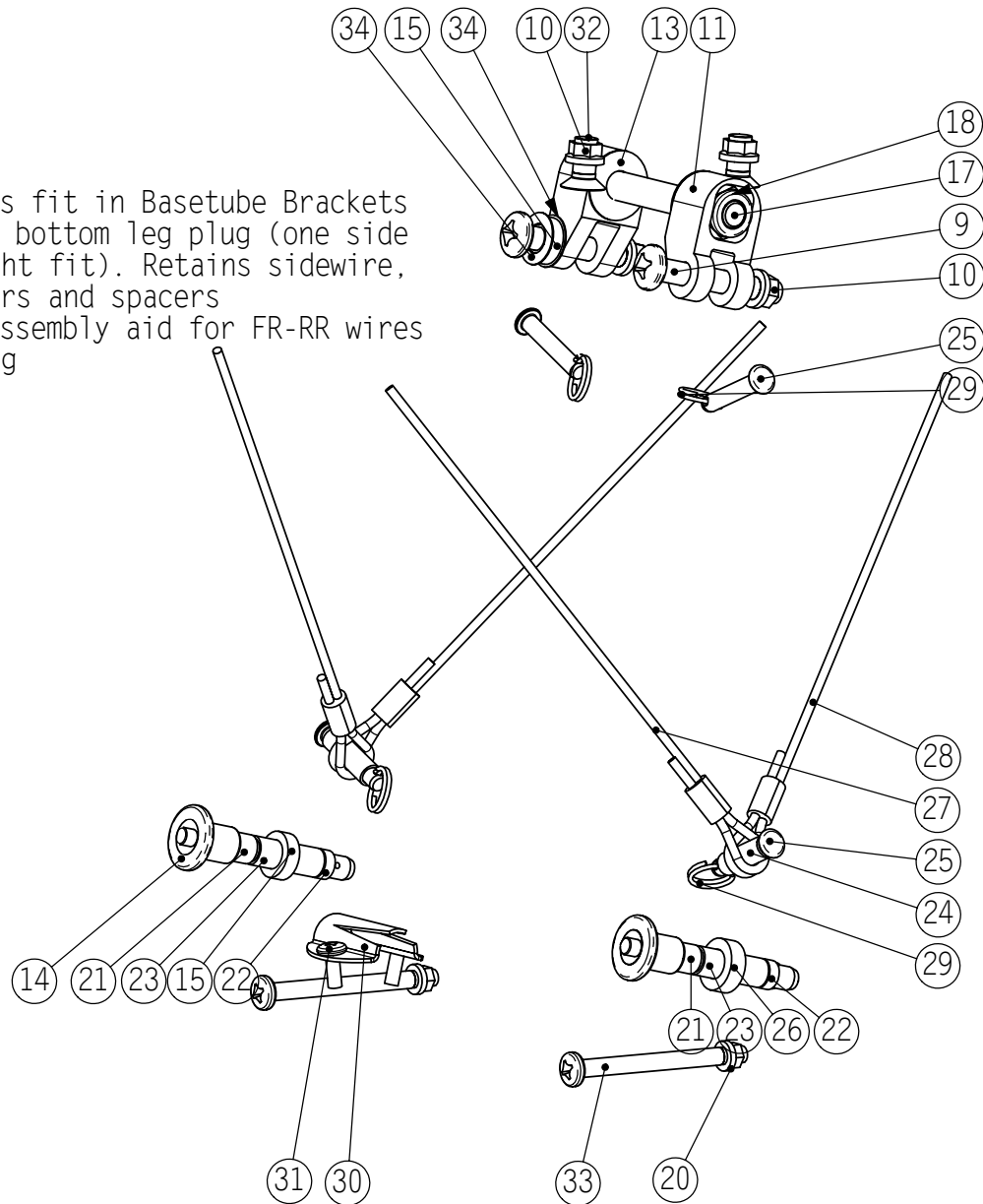

500 BLUERIDGE AVE • ORANGE, CA 92865 • PH/FAX (714) 998-6359 / 998-0647

TITLE:
U2 Litestream Control Bar Assembly

PART NO:

REVISION:
B

T.U.S. .X ± .05
.XX ± .015
.XXX ± .003
.XXXX ± .0005
ANGLES ± 1/2°

SLDDWF ID:
Litestream

MATERIAL:

DRAWN:
NA

REVISED:
5/1/2003

STATUS:
-

BY:
PEARSON